

**WARNING TO HOUSE PURCHASERS**  
Property Misdescriptions Act 1991

Buyers are warned that this is a working drawing and is not intended to be treated as descriptive material describing, in relation to any particular property or development, any of the specified matters prescribed by any Order made under the above act. The contents of this drawing may be subject to change at any time, and alterations and variations can occur during the progress of the works without revisions of the drawing. Consequently the layout, form, content and dimensions of the finished construction may differ materially from those shown. Nor do the contents of this drawing constitute a contract, part of any contract, or warranty.

**SCHEDULE OF ACCOMMODATION**

Ref	Barratt Type	House Type	Sqft	No	Total Sqft
AMB	Amber	2 bed house	565	16	9040
<b>Total number of units and square footage</b>				<b>16</b>	<b>9040</b>
<b>Gross Site Area in Acres</b>					<b>0.91</b>
<b>Open Space &amp; Undevelopable area in acres</b>					<b>0.66</b>
<b>Net Site Area in Acres</b>					<b>0.25</b>
<b>Density (units per acre)</b>					<b>64</b>
<b>Density (units per hectare)</b>					<b>158</b>
<b>Square foot / Acre</b>					<b>36,160</b>

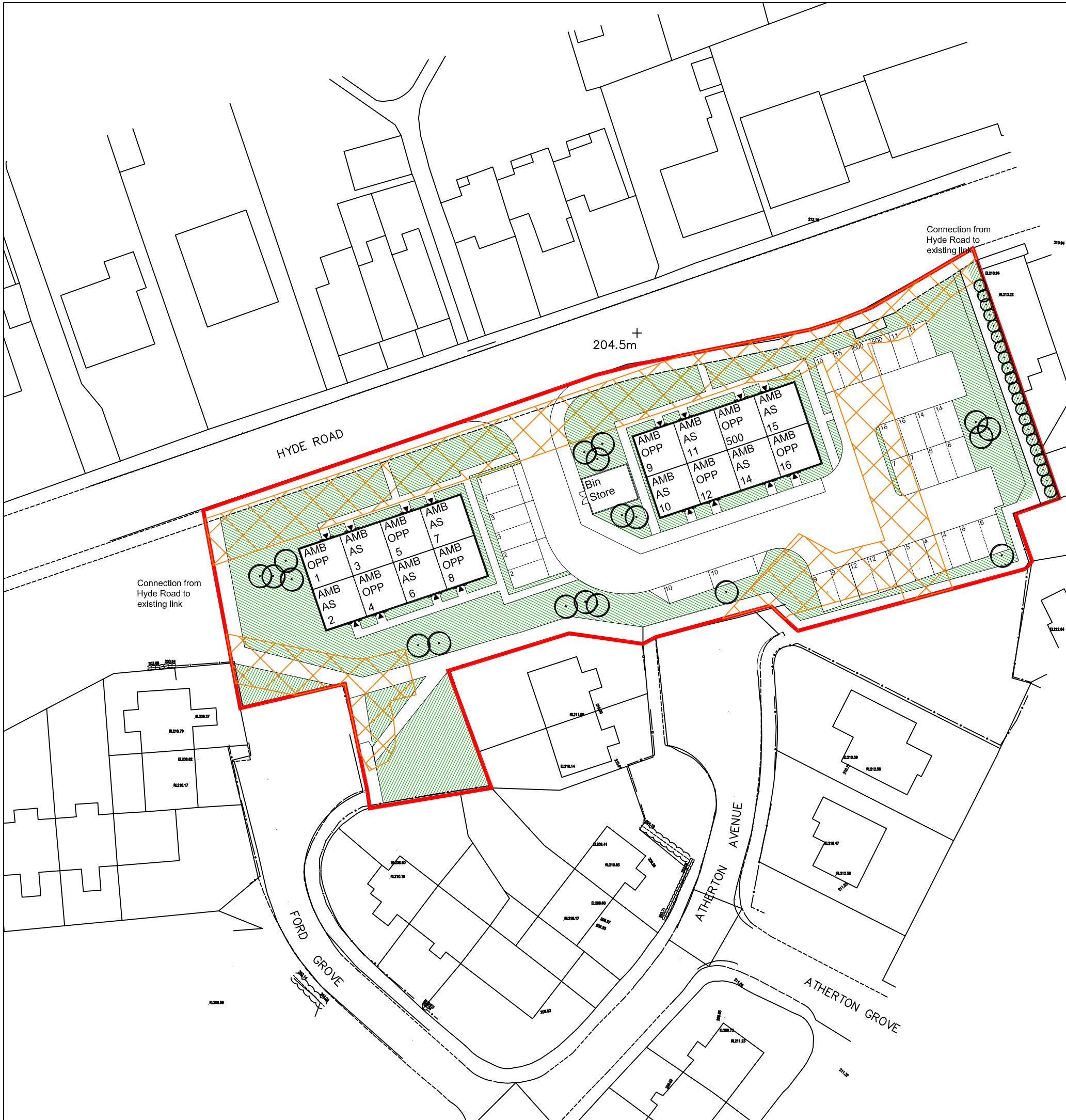

- 5 Parking & eastern link reconfigured due to comments received from LPA 17.06.20 NC
- 4 Parking for plot 12 moved to next to plot 10s due to comments received from LPA 11.06.20 NC
- 3 Parking 1 - 3 moved closer to Amber Block, parking court reconfigured to accommodate a link Atherton Avenue to the bus stop, both Amber blocks moved further to the west side of the development, private drive widened to 4.8m and a 1.8m footpath now included (all comments from LPA & LHA) 04.03.20 NC
- 2 Both block reverted to blocks of 8 to accommodate Bin Store to meet bin run distances requirements 24.10.19 NC
- 1 Link added from existing footpath off Atherton Avenue & Ford Grove linking to Hyde Road. 11.10.19 NC

Rev	Description	Date	Drawn	Chk'd
-----	-------------	------	-------	-------



**BARRATT  
HOMES  
MANCHESTER**

Barratt Homes Manchester  
(A division of BDW Trading Ltd)  
4 Brindley Road  
City Park  
Manchester  
M16 9HQ  
Tel: 0161 872 0161  
Fax: 0161 855 2828

Job HATTERSLEY PHASE 7  
SITE 28

Title PLANNING LAYOUT

Design By	Date	Drawing Number	Rev
NC	OCT 2019	486 - P - PL - 01	5
Drawn By	Scale @ A3		
NC	1:500		